

ROOTES
GROUP
Arrangements

1958

INTERNATIONAL
MOTOR EXHIBITION

EARLS COURT
OCT. 22ND - NOV. 1ST 1958

HUMBER · HILLMAN · SUNBEAM
THRUPP & MABERLY · ROOTES ACCEPTANCES
BRITISH LIGHT STEEL PRESSINGS

INDEX

STAND NUMBERS	2
ROOTES GROUP OFFICES	3
ROOTES GROUP SALES PERSONNEL	4
DEALERS' ROOM & CLOAKROOM	3 & 5
EXPORT ARRANGEMENTS	6
GROUP FLEET SALES ORGANIZATION	7
PERSONNEL IN ATTENDANCE	8-15
Humber	8
Hillman	9
Sunbeam	10
Service Division	11
Parts Division	12
Thrupp & Maberly	13
British Light Steel Pressings	14
Rootes Acceptances	15
EXHIBITS	16-23
Humber	16
Hillman	17-18
Sunbeam	19
Thrupp & Maberly	20
B.L.S.P. Ltd.	21
Marine Section	22
Garage Equipment	22
Pressed Steel Co. Ltd.	23
Harold Radford	23
ROOTES LIMITED ARRANGEMENTS	24-25
Devonshire House	24
Ladbroke Hall & Halkin House	25
DEMONSTRATION RUNS & TRANSPORT ARRANGEMENTS	26
SALES PROMOTION AND ADVERTISING	27
PRESS AND PUBLIC RELATIONS	28
MODELS AND PRICES	29
SPECIAL ACCESSORIES AND PRICES	30-36

For location of Stands, see Map of Earls Court on
inside back cover

STAND NUMBERS

HUMBER Stand No. 146

Telephone - - - FULham 8582/7

HILLMAN Stand No. 162

Telephone (Home & Export) FULham 8582/7

SUNBEAM Stand No. 159

Telephone - - - FULham 8582/7

THRUPP & MABERLY Stand No. 101

Telephone - - - FULham 4291

**BRITISH LIGHT STEEL
PRESSINGS** Stand No. 98

Telephone - - - FULham 7182

**ROOTES
ACCEPTANCES LTD.** Stand No. 9

Telephone - - - FULham 8984

HAROLD RADFORD Stand No. 107

Telephone - - - FULham 6806

**For Special Display at Devonshire House,
Ladbroke Hall and Halkin House**

(see pages 24 and 25)

ROOTES GROUP OFFICES

The following are all located on the first floor, immediately over Warwick Road entrance :

Sales General Office :

Room No. 54 - - - Tel. FULham 8582/7

Directors' Office :

Room No. 53 - - - Tel. FULham 8582/7

Rootes Group Dealers' Room :

Tel. FULham 7221 and 7222

Rootes Group Dealers' Cloakrooms :

(See Map Below)

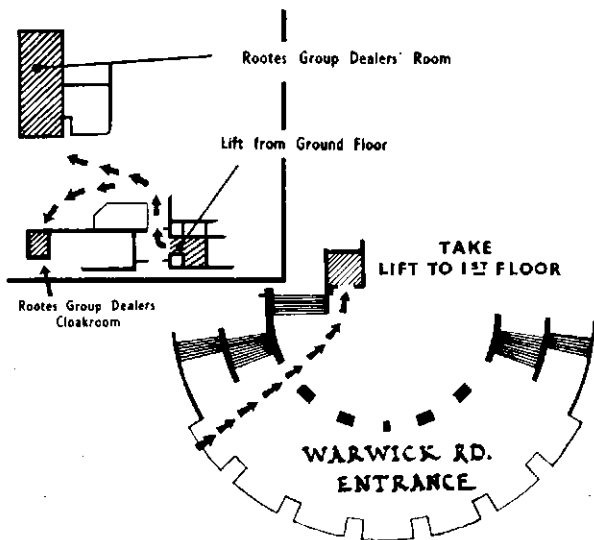

ROOTES GROUP SALES PERSONNEL

Sales Manager
(Humber, Hillman, Sunbeam) :

Mr. Desmond Rootes

Sales Promotion and Competitions Manager
(Humber, Hillman, Sunbeam) :

Mr. Norman Garrad

Assistant Sales Manager :

Mr. J. A. Lee

Territorial Liaison :

Mr. L. J. Hodson

Sales Representatives :

Mr. R. W. Amooore

Mr. W. T. Alden

Mr. G. Bryan

Mr. C. H. Beresford

Mr. D. R. Humphrey

Mr. A. E. Farrant

Mr. W. Pearce

Mr. C. W. Hough

Mr. B. N. Wright

Mr. W. F. Kemball

Mr. P. M. Stock

Mr. D. Haddon

ROOTES GROUP DEALERS' ROOM AND CLOAK ROOM

For the benefit of Rootes Group Dealers, both from home and overseas, a large and well furnished room has been provided on the first floor, immediately above the Warwick Road entrance, opposite the administrative offices. (See map on page 3.)

In this room will be found facilities for private negotiations, correspondence, etc., these amenities are available to all Dealers of the Rootes Group, who, it is hoped, will make full use of them.

A separate Cloakroom for Dealers' hats and coats has been provided for Rootes Group Dealers, and this will be found on the first floor opposite the entrance to the Dealers' Room. (See map on page 3.)

EXPORT ARRANGEMENTS

There will be representatives of Rootes Ltd., Export Division, with lapel badges marked "Export" on all Group Stands, and Overseas enquiries of every description should be referred immediately to one of these representatives.

On the Hillman Stand the representative will be found in The Kiosk, part of which is being reserved for the Export Division.

(Telephone FULham 8582/7)

A cordial invitation is extended to all Overseas Dealers to make full use of the Rootes Group Dealers' Room and Cloakroom as described on page 5.

It is specially requested that all Overseas Visitors are given the utmost attention, assistance and courtesy.

GROUP FLEET SALES ORGANISATION

GROUP FLEET SALES OFFICE

Head Office :

Devonshire House (Grosvenor 3401)

The following persons will be in attendance :

Administrative Manager :

Mr. P. Murray Lee

Wholesale Fleet Representative :

Mr. E. L. Lingard

Records and Statistics :

Mr. C. W. Meeks

HUMBER STAND No. 146

PERSONNEL IN ATTENDANCE

Sales Manager :

Mr. Desmond Rootes

Sales Promotion Manager :

Mr. N. Garrad

Sales Representatives :

Mr. R. W. Amooore	Mr. W. F. Kemball
Mr. F. C. Dronfield	Mr. B. A. Charter
Mr. C. H. Beresford	Mr. C. W. Hough
Mr. A. G. C. Davies	Mr. K. F. Ault
Mr. F. S. Large	Mr. A. G. James
Mr. H. I. S. Brounger	Mr. M. F. Andrews
Mr. R. Gascoyne	Mr. A. Charnell

Service Representatives :

Mr. H. A. Taylor	Mr. J. W. K. Bannell
Mr. G. B. Stevens	

Technical Representatives :

Mr. C. L. Jones (<i>Chassis</i>)	Mr. N. Scutter (<i>Chassis</i>)
Mr. D. T. Cobb (<i>Body</i>)	Mr. P. N. Patrick (<i>Body</i>)

These technical representatives cover all three stands—Humber, Hillman and Sunbeam—and there will always be on duty one Chassis and one Body representative.

Parts Representatives :

(For particulars see page 12)

Demonstration Drivers :

Mr. J. Mitchell	Mr. R. Stewart
Mr. H. Cook	

HILLMAN STAND No. 162

PERSONNEL IN ATTENDANCE

Sales Manager :

Mr. Desmond Rootes

Sales Promotion Manager :

Mr. N. Garrad

Sales Representatives :

Mr. W. Pearce	Mr. G. Bryan
Mr. A. Traynor	Mr. R. J. L. Wilson
Mr. A. E. Farrant	Mr. D. S. Noble
Mr. R. A. Girling	Mr. D. H. Simmons
Mr. R. S. M. Coombs	Mr. F. G. Pelling
Mr. E. G. Allison	Mr. J. Williamson
Mr. R. Beaden	Mr. R. E. Owen
Mr. C. J. G. Hackforth	Mr. D. Witts
Mr. C. W. Power	Mr. G. A. Buckley
Mr. J. A. Mitchell	Mr. J. F. Harris
Mr. R. S. Dickinson	Mr. D. G. C. Hebblethwaite
Mr. E. E. Unger	Mr. P. R. Cook
Mr. M. P. Moreton	Mr. J. R. Plaskett
Mr. R. C. H. Mead	Mr. G. M. Bayles

Service Representatives :

Mr. C. O. Bower	Mr. J. D. B. Aird-Mash
Mr. C. A. Richmond	

Technical Representatives :

(For particulars see Humber Stand, page 8)

Parts Representatives :

(For particulars see page 12)

Demonstration Drivers :

Mr. B. A. Browning	Mr. G. Meredith
Mr. P. S. Keeling	

SUNBEAM STAND No. 159

PERSONNEL IN ATTENDANCE

Sales Manager :

Mr. Desmond Rootes

Sales Promotion and Competitions Manager :

Mr. N. Garrad

Sales Representatives :

Mr. B. N. Wright

Mr. J. H. Cock

Mr. W. T. Alden

Mr. J. L. Sexty

Mr. F. L. Smith

Mr. I. D. Bannerman

Mr. N. J. Bell

Mr. R. J. Donaldson

Mr. D. R. Humphrey

Mr. J. Nelson

Mr. A. W. Beston

Mr. R. C. Scarr

Mr. P. S. Badenoch

Mr. A. Willis

Mr. S. Willis

Mr. L. W. Garrad

Service Representatives :

Mr. A. R. Jones

Mr. D. C. Kennett

Mr. J. W. Jellicoe

Technical Representatives :

(For particulars see Humber Stand page 8)

Parts Representatives :

(For particulars see page 12)

Demonstration Drivers :

Mr. C. V. Pimlett

Mr. P. J. Cox

Mr. A. W. Nicholls

SERVICE DIVISION ARRANGEMENTS

Group Service Manager :

Mr. O. D. Horton

Service Manager (Cars) :

Mr. M. T. Mould

Assistant Service Manager (Cars) :

Mr. J. H. Chambers

Service representatives will be on duty at the Humber, Hillman and Sunbeam stands. (See pages 8, 9 and 10.)

Mr. D. W. Hutton and Mr. J. T. Treharne, of the Group Development Section, will be on duty to give advice on equipment, tools, etc., to Dealers. Enquiries should be made at the Rootes Group Dealer Lounge, situated on the first floor, opposite the Warwick Road entrance.

PARTS DIVISION ARRANGEMENTS

General Manager :

Mr. R. Watson Lee

Sales Manager :

Mr. J. H. Woodin

Home Sales Executive :

Mr. F. W. Lewis

Export Sales Executive :

Mr. J. H. Berridge

The following Parts Representatives will be on duty throughout the period of the Show based on the HUMBER STAND No. 146 and the HILLMAN STAND No. 162. All enquiries relating to Parts and Accessory matters—either Home or Export—should be referred to these Representatives.

Mr. P. L. Greer

Mr. T. D. Jobling

Mr. L. Prynne

Mr. C. T. Musckett

Leaflets giving details of Rootes Group Special Accessories for all current models are available from the Stand Kiosks on application. (See also pages 30-36)

THRUPP & MABERLY STAND
No. 101
PERSONNEL IN ATTENDANCE

COACHBUILDING SECTION

Director and General Manager :

Mr. H. W. Light

Sales Representatives :

Mr. G. Pilmore-Bedford

Mr. C. Brownson

Mr. J. Curtis

Mr. A. K. Parker

Mr. N. A. Falconer

Mr. W. A. Cooke

Mr. T. T. Neyland

Mr. P. R. Empey

Technical Representatives :

Mr. W. F. Warden

Mr. E. S. Heathcote

BRITISH LIGHT STEEL PRESSINGS Ltd.
PERSONNEL ARRANGEMENTS
STAND No. 98 GROUND FLOOR

Rootes Group Dealers will be cordially welcomed at this Stand which is located in the Carriagework Section.

General Manager :

Mr. H. A. G. Livock

Commercial Manager :

Mr. T. P. Bagge

Sales Engineer :

Mr. I. L. Jones

Sales Representatives :

Mr. D. Haddon

Mr. P. M. Stock

Mr. H. Solomons

Mr. A. Mace

Mr. T. Cotton

Mr. O. V. Le Maitre

Mr. M. Rowe

Mr. D. H. Davies

Mr. A. E. Cussen

Mr. B. G. Hughes

Technical Representatives :

Mr. C. G. Jackson

Mr. R. W. French

Mr. A. Pout

ROOTES ACCEPTANCES LTD. PERSONNEL ARRANGEMENTS STAND No. 9 GROUND FLOOR

Rootes Acceptances Ltd., serving exclusively Rootes Group Dealers, provides a comprehensive financial service to every trader holding a Rootes Group contract.

Wholesale Finance Facilities. The plans enable Traders to carry a wide range of models in stock and for demonstration.

Retail Finance. This covers all types of vehicles—new and second-hand—private and commercial. Charges for all classes of business are moderate and for new Group vehicles our preferential rates are proving a very positive selling aid. Special quotations can be offered on fleet orders. Service is prompt and efficient, and normal business is transacted without recourse to the Supplier.

Equipment. Rootes Group Dealers may obtain favourable terms for installation in their own premises of garage plant, machinery and capital equipment.

You are cordially invited to visit Rootes Acceptances Ltd., when the following persons will be glad to welcome you.

General Manager :

Mr. J. Harris

In Attendance :

Mr. J. C. Barratt
Mr. C. McNicoll
Mr. M. J. Greengrass
Mr. A. F. Screech

Mr. R. Porrer
Mr. J. J. Rose
Mr. A. C. Watkins
Mr. R. F. Macadam

HUMBER STAND No. 146

EXHIBITS

	Basic Price	Purchase Tax	Total
16 SUPER SNIPE SALOON (Plinth Car). Embassy Black/ Windsor Blue. Smith radio, W/W tyres	£995	£498 17 0	£1493 17 0
SUPER SNIPE SALOON. Smoke Green/Sage Green. Automatic drive, Power steering, Reutter seats, Ekco radio, W/W tyres	£995	£498 17 0	£1493 17 0
HAWK SALOON. Glacier Blue/Fathom Grey. Overdrive, Smith radio, heater, rimfinishers, W/W tyres	£840	£421 7 0	£1261 7 0
HAWK ESTATE CAR. Seal Grey/Dawn Mist. Overdrive, Ekco radio, heater, rimfinishers, W/W tyres	£995	£498 17 0	£1493 17 0

(For prices of special accessories see page 30 31 and 32.)

EXHIBITS

	Basic Price	Purchase Tax	Total
MINX DE LUXE SALOON. Foam Grey/Calypso Red. Smith radio, heater, overriders, rimfinishers, clock, W/W tyres	£529	£265 17 0	£794 17 0
MINX CONVERTIBLE COUPE (Plinth Car). Powder Blue (Corinth Blue hood). Ekco radio, heater, overriders, rimfinishers, clock, W/W tyres ...	£598	£300 7 0	£898 7 0
MINX DE LUXE SALOON. Foam Grey/Ocean Blue. Manumatic transmission, bucket seats, Smith radio, heater, overriders, clock, W/W tyres	£529	£265 17 0	£794 17 0
MINX DE LUXE SALOON (Plinth Car). Powder Blue/ Charcoal. Ekco radio, heater, overriders, rimfinishers, clock, W/W tyres	£529	£265 17 0	£794 17 0

(For prices of special accessories see pages 32 33 34 and 35)

EXHIBITS

	Basic Price	Purchase Tax	Total
MINX SPECIAL SALOON. Seacrest Green. Ekco radio heater, overrides, rimfinishers, clock, second visor, W/W tyres	£498	£250 7 0	£748 7 0
MINX CONVERTIBLE COUPE Moonstone (Black hood). Smith radio, heater, overrides, rimfinishers, clock, W/W tyres	£598	£300 7 0	£898 7 0
HILLMAN ESTATE CAR. Cypress Green/Cloud White. Smith radio, heater, overrides, rimfinishers, clock, W/W tyres	£598	£300 7 0	£898 7 0
HILLMAN HUSKY. Pippin Red/Foam Grey. Ekco radio, heater, overrides, rimfinishers, clock, second visor, W/W tyres	£465	£233 17 0	£698 17 0

(For prices of special accessories see pages 32 33 34 and 35)

EXHIBITS

	Basic Price	Purchase Tax	Total
RAPIER CONVERTIBLE Pearl Grey/Pippin red (Pippin Red hood). Overdrive, Ekco radio, heater, clock, rev. counter, W/W tyres	£735	£368 17 0	£1103 17 0
61 RAPIER SALOON (Plinth Car). Moonstone/Powder Blue. Overdrive, Ekco radio, heater, clock, rev. counter, W/W tyres	£695	£348 17 0	£1043 17 0
RAPIER SALOON. Corinth Blue/Embassy Black. Overdrive, Ekco radio, heater, clock, rev. counter, W/W tyres	£695	£348 17 0	£1043 17 0
RAPIER SALOON. Cypress Green/Iceberg Green. Overdrive, Ekco radio, heater, clock, rev. counter, W/W tyres	£695	£348 17 0	£1043 17 0

(For prices of special accessories see page 36)

EXHIBITS

	Basic Price	Purchase Tax	Total
HUMBER SUPER SNIPE LIMOUSINE. Burgundy. Borg Warner, Power steering, Smith radio, W/W tyres	£1095	£548 17 0	£1643 17 0
20 SUNBEAM RAPIER SALOON. Windsor Blue/Corinth Blue. Overdrive, Smith radio, heater, clock, rev. counter, W/W tyres	£695	£348 17 0	£1043 17 0
SUNBEAM RAPIER CONVERTIBLE Moonstone/ Morocco Brown (Morocco Brown hood). Smith radio, heater, clock, rev. counter, W/W tyres	£735	£368 17 0	£1103 17 0
SUNBEAM RAPIER SALOON. Glacier Blue/Embassy Black. Overdrive, Ekco radio, heater, clock, rev. counter, W/W tyres	£695	£348 17 0	£1043 17 0
HLILMAN MINX CONVERTIBLE. Pippin Red (Black hood). Smith radio, heater, clock, over- riders, rimfinishers, W/W tyres	£598	£300 7 0	£898 7 0

EXHIBITS

		Basic Price	Purchase Tax	Total
	HUMBER SUPER SNIPE ESTATE CAR. Sage Green/ Smoke Green. Overdrive, Ekco radio, W/W tyres	£1160	£581 7 0	£1741 7 0
21	HUMBER SUPER SNIPE SALOON. Fathom Grey/ Glacier Blue. Automatic drive, Power steering, Reutter seats, Ekco radio, W/W tyres	£995	£498 17 0	£1493 17 0
	HUMBER HAWK SALOON. Burgundy/Cavalry Beige. Automatic drive, Reutter seats, Ekco radio, heater, rimfinishers, W/W tyres	£840	£421 7 0	£1261 7 0
	HUMBER HAWK LIMOUSINE. Embassy Black. Overdrive, Smith radio, heater, rimfinishers, W/W tyres	£920	£461 7 0	£1381 7 0

MARINE SECTION

	Stand No.	Exhibit
Lister Blackstone (Marine) Ltd.	21	Rootes-Lister fresh water cooled marine propulsion engine, 3 $\frac{1}{4}$ " bore, 4 stroke, 3 cylinder, opposed piston type. Rated at 80 h.p. at 1800 r.p.m. with sump lubrication, reverse and 2-1 reduction gear, electric starting.

22

GARAGE EQUIPMENT SECTION

	Stand No.	Exhibit
Joseph Bradbury & Sons Ltd.	505	HUMBER HAWK SALOON. CorinthBlue/ Windsor Blue
Aerograph Co., Ltd.	503	HILLMAN MINX DE LUXE SALOON. Foam Grey/Antelope
Triangle Products Ltd.	494	SUNBEAM RAPIER SALOON. Pearl Grey/PippinRed

PRESSED STEEL CO. ..**STAND No. 111****EXHIBITS**

23

	Basic Price	Purchase Tax	Total
HILLMAN MINX DE LUXE SALOON. Foam Grey/ Calypso Red. Smith radio, heater, overriders, rim- finishers, clock, W/W tyres	£529	£265 17 0	£794 17 0
HILLMAN HUSKY. Seacrest Green/Foam Grey. Ekco radio, heater, overriders, rimfinishers, clock, second visor, W/W tyres	£465	£233 17 0	£698 17 0

HAROLD RADFORD**STAND No. 107****EXHIBIT**

	Basic Price	Purchase Tax	Total
HUMBER SUPER SNIPE SALOON. Seal Grey/Dawn Mist. Borg Warner, Reutter seats, Smith radio, W/W tyres	£995	£498 17 0	£1493 17 0

**SPECIAL DISPLAY
AT
ROOTES LTD.
DEVONSHIRE HOUSE, PICCADILLY
LONDON, W.1**

Telephone : Grosvenor 3401

The following cars will be on show at Devonshire House :

Humber :

Hawk Saloon	Burgundy/Cavalry Beige
Hawk T/Limousine	Black
Super Snipe Saloon...	Seal Grey/Dawn Mist
Super Snipe Saloon...	Sage Green/Smoke Green
Super Snipe Estate	Grey Metallic

Hillman :

De Luxe Saloon	Charcoal/Foam Grey
De Luxe Saloon	Foam Grey/Ocean Blue
Convertible	Pippin Red/Black Hood
Estate Car	Cypress Green/Cloud White
Special Saloon	Antelope
Husky	Powder Blue/Foam Grey

Sunbeam :

Rapier Saloon	Glacier Blue/Black
Rapier Convertible	Morocco Brown/Moonstone Flash

SPECIAL DISPLAY

at

ROOTES LTD.

LADBROKE HALL, BARLBY ROAD
NORTH KENSINGTON, LONDON, W.10

Telephone : Ladbroke 3232

ROOTES LTD.

HALKIN HOUSE, 5-6 HALKIN STREET
WESTMINSTER, LONDON, S.W.1

Telephone : Sloane 3478

The following cars will be on show at Ladbroke Hall :

Humber :

Hawk Estate...	Windsor Blue/Pearl Grey
Super Snipe T/Limousine	...		Burgundy

Hillman :

De Luxe Saloon	Powder Blue/Charcoal
Husky	Antelope/Foam Grey

Sunbeam :

Rapier Convertible...	...	Windsor Blue/Corinth Blue
-----------------------	-----	---------------------------

The following car will be on show at Halkin House :

Hillman :

Convertible	Powder Blue
-----------------	-----	-------------

DEMONSTRATION RUNS & TRANSPORT ARRANGEMENTS

Trial runs can be arranged on the following models, and if these are taken during Exhibition hours, special arrangements have been made whereby clients can be re-admitted, without further charge to the show, after a trial run. These facilities, however, are strictly limited by regulations to certain cars only, and it is important that when re-admission facilities are required, these must be stated before the run is given. All enquiries for trial runs should be made to the Kiosk on the Stand of the manufacturer concerned.

As a heavy demand for demonstrations is anticipated, the time available for each run may be limited by circumstances, and special routes have been selected.

Humber	Super Snipe Saloon	Smoke Green/Sage Green
	Super Snipe Estate Car	Sage Green/Smoke Green
	Super Snipe Saloon	Fathom Grey/Glacier Blue
	Hawk Saloon	Embassy Black/Thistle Grey
	Hawk Saloon	Dawn Mist/Seal Grey
	Hawk Estate Car	Pearl Grey/Windsor Blue
Hillman	Minx de luxe Saloon	Charcoal/Foam Grey
	Minx de luxe Saloon	Foam Grey/Ocean Blue
	Minx de luxe Saloon	Powder Blue/Charcoal
	Minx Convertible Coupe	Moonstone (Powder Blue Hood)
	Special Saloon	Ocean Blue
	Husky	Powder Blue/Foam Grey
	Estate Car	Windsor Blue/Cloud White
Sunbeam	Rapier Saloon	Moonstone/Morocco Brown
	Rapier Saloon	Corinth Blue/Embassy Black
	Rapier Convertible	Glacier Blue/Embassy Black

SALES PROMOTION AND ADVERTISING FACILITIES HUMBER · HILLMAN · SUNBEAM

Group Advertising and Sales Promotion Manager :
Mr. W. Elsey

Co-operative Advertising (Cars) :
Mr. A. J. Coleman (Home)
Mr. P. A. Ryan (Export)

Members of the Sales Promotion and Advertising Departments will be on duty on the above Stands during the period of the Show, to give Rootes Group Dealers every possible assistance in connection with their Sales Promotion and Advertising Campaigns.

A most generous and comprehensive Sales Promotion Service is available, covering :—

- Press Advertising.
- Sales Literature and Posters.
- Interior and Exterior Signs.
- Direct Mail.
- Cinema Slides.
- Films.
- Forecourt and Outdoor Advertising.
- Showroom Displays, etc., etc.

New Press Advertising stereotypes are now ready, covering all models, including those recently announced, and the fullest facilities are offered to assist dealers in planning forceful Sales Campaigns in their territory.

Please make maximum use of this service.

PRESS ARRANGEMENTS AND PUBLIC RELATIONS

In addition to Mr. A. J. Bullock (Chief Public Relations Officer), the following Press Relations Officers named below will be on duty throughout the Exhibition on Group Stands : Mr. T. R. Mulcaster, Mr. J. Wilcox, Mr. W. A. Hunter, Mr. T. P. Walsh, Mr. J. Rowe, Mr. M. G. Trestrail, and Mrs. J. Wilkinson.

Reception of Press

It is vitally important that no opportunity should be lost to interest the PRESS in the Group's activities and they should receive every courtesy.

Apart from journalists, there will be photographers, newsreel cameramen and broadcasting commentators. In every case, visitors of this character should be referred to the Public Relations Officials, or, if they are engaged, to one of the Sales Managers and to no other Group representative.

Any events or developments which might be useful for publicity, should be made known as early as possible to Public Relations, and messages can be left in the special box labelled "**Public Relations**" which will be available in the kiosk on each stand. It should be borne in mind that this special box is for the exclusive use of the Public Relations Department.

LIST OF MODELS AND PRICES

Model	Basic Price			Purchase Tax			Total		
	£	s.	d.	£	s.	d.	£	s.	d.
HUMBER									
Super Snipe Saloon ...	995	0	0	498	17	0	1493	17	0
" " Limousine	1095	0	0	548	17	0	1643	17	0
" " Estate Car	1160	0	0	581	7	0	1741	7	0
Hawk Saloon ...	840	0	0	421	7	0	1261	7	0
" " Limousine	920	0	0	461	7	0	1381	7	0
" " Estate Car	995	0	0	498	17	0	1493	17	0
*Overdrive ...	50	0	0	25	0	0	75	0	0
*Borg-Warner Transmission ...	115	0	0	57	10	0	172	10	0
*Reutter Seats ...	35	0	0	17	10	0	52	10	0
*Power Assisted Steering (Super Snipe only)	55	0	0	27	10	0	82	10	0
White Wall Tyres									
Hawk Saloon and Limousine ...	8	7	6	4	3	9	12	11	3
Hawk Estate Car ...	10	10	0	5	5	0	15	15	0
Super Snipe Saloon and Limousine	10	10	0	5	5	0	15	15	0
Super Snipe Estate Car	12	7	6	6	3	9	18	11	3
HILLMAN									
Minx De Luxe Saloon ...	529	0	0	265	17	0	794	17	0
Minx Convertible ...	598	0	0	300	7	0	898	7	0
Estate Car ...	598	0	0	300	7	0	898	7	0
Minx Special Saloon ...	498	0	0	250	7	0	748	7	0
Husky ...	465	0	0	233	17	0	698	17	0
*Two-tone colour schemes (DeLuxe Saloon only)	10	0	0	5	0	0	15	0	0
*Manumatic Transmission	25	0	0	12	10	0	37	10	0
*Bucket Seats	10	0	0	5	0	0	15	0	0
*Sliding Quarterlights (Husky only)	7	0	0	3	10	0	10	10	0
White Wall Tyres (All models)	6	12	6	3	6	3	9	18	9
SUNBEAM									
Rapier Saloon ...	695	0	0	348	17	0	1043	17	0
Rapier Convertible ...	735	0	0	368	17	0	1103	17	0
*Overdrive ...	42	10	0	21	5	0	63	15	0
White Wall Tyres ...	6	12	6	3	6	3	9	18	9

*Factory fitted only when car is manufactured.

LIST OF SPECIAL ACCESSORIES AND PRICES

Prices include Purchase Tax where applicable
but not fitting charges

	Price
HUMBER SUPER SNIPE	
Liquid Polish	3 0
Wax Polish	5 0
Badge Clips	5/3 & 3/6
Door Mirror	19 6
Wing Mirror	19 6
Rebound Mirror	£1 2 6
Multipurpose Cushion	£1 15 0
Sheepskin Rugs—front compartment	£9 14 1
Sheepskin Rugs—rear compartment	£8 16 2
Safety Belts each	£3 5 0
Lamp Carriers	15 6
Badge Bar	£2 7 6
Roof Rack	£6 6 0
Exterior Sun Visor	£4 15 0
Spare Wheel Cover	£1 10 0
Dog Guard	£8 15 0
Perspex Interior Visors	£1 15 0
Seat Covers	Prices on application
Fog Lamp	£3 15 6
Driving Lamp (alternative Black Knob available)	£3 15 6
Petrol Locking Cap	£1 12 6
Fire Extinguisher	£2 15 0
Tow-bar	£7 5 0
Limousine Rear Compartment Heater	£15 0 0
Petrol Funnel	6 3
White Wall Tyre Trims (set of four)	£3 5 0
Radio (including Aerial and Accessories) :	
Radiomobile De Luxe (Twin Speakers)	£42 17 6
Radiomobile Standard	£23 12 6
Ekco (Twin Speakers)	£25 18 0

Accessories listed refer to all models in the range unless otherwise stated

LIST OF SPECIAL ACCESSORIES AND PRICES

Prices include Purchase Tax where applicable
but not fitting charges

HUMBER HAWK

Saloon, Touring Limousine and Estate Car :	Price
Fog Lamp	£3 14 6
Driving Lamp (alternative black knob available) ...	£3 14 6
Petrol Locking Cap	£1 12 6
Radiator Blind	£3 12 6
Cigar Lighter	£1 8 1
Rimfinisher (set of four)	£5 5 0
Fire Extinguisher	£2 15 0
Wheel Discs (set of four)	£10 0 0
Oil Gauge	£2 5 0
Heater Kit	£18 0 0
Ammeter	£1 0 0
Exhaust Deflector (not Estate Car)	15 0
Tow-bar	£7 5 0
Windscreen Washer—hand operated	£1 15 0
Windscreen Washer—Electric	£3 14 6
Limousine Rear Compartment Heater	£26 0 0
Petrol Funnel	6 3
Liquid Polish	3 0
Wax Polish	5 0
Badge Clips	5/3 & 3/6
Door Mirror	19 6
Wing Mirror	19 6
Mascot	17 6
Rebound Wing Mirror	£1 2 6
Multipurpose Cushion	£1 15 0
Sheepskin Rugs—front compartment	£9 14 1
Sheepskin Rugs—rear compartment	£8 16 2
Safety Belts each	£3 5 0
Lamp Carriers	15 6
Badge Bar	£2 7 6
Roof Rack	£6 6 0
Perspex Interior Visors	£1 15 0
Exterior Sun Visor	£4 15 0
Spare Wheel Cover (not Estate Car)	£1 10 0
Touch-in Pens	4 9

Accessories listed refer to all models in the range unless otherwise stated

LIST OF SPECIAL ACCESSORIES AND PRICES

Prices include Purchase Tax where applicable
but not fitting charges

HUMBER HAWK—contd,

Price

Seat Covers	Prices on application
Dog Guard (Estate Car only)	£8 15 0
White Wall Tyre Trims (set of four)	£3 5 0
Radio (including Aerial and Accessories) :	
Radiomobile De Luxe	£36 2 1
Radiomobile Standard	£23 17 6
Ekco De Luxe	£32 0 0
Ekco Standard	£25 18 0
Dipping Mirror	£1 2 6

HILLMAN MINX

De Luxe Saloon and Convertible Special Saloon and Estate Car

Price

Driving Lamp	£3 14 6
Fog Lamp	£3 14 6
Badge Bar and Lamp Carrier	£2 7 6
Overriders (set of four)	£4 10 0
Rimfinishers (set of five)	£5 5 0
Bonnet Mascot	17 6
Sheepskin Rugs—front compartment (R.H.D.) only	£7 12 2
Centre Armrest (trimmed in Bright Red, Seacrest Green, Light Grey, Ocean Blue and Powder Blue) (not Convertible)	£3 2 6
Wing Mirror	19 6
Rebound Wing Mirror	£1 2 6
Windscreen Washer	£1 17 6
Exterior Sun Visor (in Primer)	£4 2 6
Roof Rack (not Convertible)	£5 0 0
White Wall Tyre Trims (set of four)	£3 5 0
Wheel Discs (set of four)	£10 0 0
Side Armrests—front door (colours as item 8)	£1 10 0
Side Armrests—rear door (colours as item 8)	£1 17 6
Reverse Lamp	£1 8 6
Tow-bar Attachment	£7 10 0
Petrol Locking Cap	£1 1 0
Boot Floor Mat (not Estate Car)	£2 0 0

Accessories listed refer to all models in the range unless otherwise stated

LIST OF SPECIAL ACCESSORIES AND PRICES

Prices include Purchase Tax where applicable
but not fitting charges

HILLMAN MINX—contd.

	Price
Heater and Demister Kit (not Special Saloon) ...	£12 0 0
Blower Kit (optional for temperate climates) ...	£4 10 0
Door Mirror	19 6
Electric Clock (not Special Saloon)	£5 10 3
Ammeter (not Special Saloon)	15 6
Oil Pressure Gauge (not Special Saloon)	£2 15 0
Radio (including Aerial and Accessories) :	
Radiomobile De Luxe (not Special Saloon) ...	£37 5 2
Radiomobile Standard (not Special Saloon) ...	£24 17 6
Ekco (not Special Saloon)	£22 15 0
Ekco Rear Extension Speaker with Volume Control (not Estate Car)	£3 2 6
Ekco Alternative Fully Retractable Aerial ...	£2 5 0
Cigar Lighter	£1 8 1
Vanity Mirror	9 8
Perspex Interior Visor	£1 12 6
Spare Wheel Cover (not Estate Car)	£1 10 0
Remote Control Centre Gearshift	£9 0 0
Fire Extinguisher	£2 15 0
Multipurpose Cushion	£1 15 0
Touch-in Pens	4 9
Paint Sprays	10 6
Matching Paint Kits	8 6
Minx Special Saloon only :	
Either Electric Clock	£4 3 6
or Thermometer	£2 12 6
Heater or Demister Kit	£12 0 0
Blower Kit (optional for temperate climates) ...	£4 10 0
Pedal Pad	2 0
Second Windtone Horn	£2 9 6
Remote Control Bonnet Lock	14 6
Floor Ash Tray	£1 8 1
Rear Compartment Ash Tray	£1 4 4
Radio (including Aerial and Accessories) :	
Radiomobile De Luxe	£36 1 1
Radiomobile Standard	£23 7 6

Accessories listed refer to all models in the range unless otherwise stated

LIST OF SPECIAL ACCESSORIES AND PRICES

Prices include Purchase Tax where applicable
but not fitting charges

HILLMAN MINX—contd.

	Price
Ekco	£22 15 0
Ekco Rear Extension Speaker with Volume Control	£3 2 6
Ekco Alternative Fully Retractable Aerial	£2 5 0
Tool Kit	£1 7 6
Badge Clips	5/3 & 3/6
Seat Covers	Prices on application
Bulb Kit (six assorted bulbs)	19 2
Radiator Blind	£3 6 0
Starting Handle	5 0
Lamp Carriers	13 6
Safety Belts each	£3 5 0
Wax Polish	5 0
Liquid Polish	3 0

HILLMAN HUSKY

	Price
Overriders (set of four)	£4 5 0
Badge Bar	£2 7 6
Fog Lamp	£3 14 6
Driving Lamp	£3 14 6
Bonnet Mascot	17 6
Wing Mirror	19 6
Rebound Wing Mirror	£1 2 6
Exterior Sun Visor	£4 2 6
Roof Rack	£5 0 0
Petrol Locking Cap	£1 1 0
Rimfinisher (set of five)	£5 5 0
Wheel Discs (set of four)	£10 0 0
Tow-bar Attachment	£5 10 0
Rear Compartment Mat	£2 9 6
Hand-operated Windscreen Washer (alternative Black Knob available)	£1 17 6
Oil Filter Kit	13 6
Matched Windtone Horn Set	£4 14 6

Accessories listed refer to all models in the range unless otherwise stated

LIST OF SPECIAL ACCESSORIES AND PRICES

Prices include Purchase Tax where applicable
but not fitting charges

HILLMAN HUSKY—contd.

	Price
Electric Clock	£4 3 6
or Thermometer	£2 12 6
Cigar Lighter	£1 8 1
Door Mirror	19 6
Pedal Rubber	2 0
Radio (including Aerial and Accessories) :	
Radiomobile De Luxe	£36 1 1
Radiomobile Standard	£23 17 6
Ekco	£22 15 0
Ekco Alternative Aerial—fully retractable	£2 5 0
Heater and Demister Kit	£12 0 0
Blower Kit (optional for temperate climates)	£4 10 0
White Wall Tyre Trims (set of four)	£3 5 0
Rootes Seat Covers	Prices on application
Vanity Mirror	9 8
Remote Control Bonnet Lock	13 0
Side Arm Rests (per pair)	£1 10 0
Fire Extinguisher	£2 15 0
Safety Belts (front seats only) each	£3 5 0
Multipurpose Cushion	£1 15 0
Tool Kit	£1 7 6
Radiator Blind	£3 6 0
Badge Clip—screw fixing	3 6
Badge Clip—pillar stud fixing	5 3
Perspex Interior Visor	£1 12 6
Bulk Kit (set of six assorted bulbs)	19 2
Starting Handle	5 0
Body Paint Touch-in Pens	4 9
Wax Polish	5 0
Liquid Polish	3 0
Lamp Carriers	13 6
Ash Tray	£1 8 1

Accessories listed refer to all models in the range unless otherwise stated

LIST OF SPECIAL ACCESSORIES AND PRICES

**Prices include Purchase Tax where applicable
but not fitting charges**

SUNBEAM RAPIER						Price
Badge Bar	£2 7 6
Driving Lamp	£3 14 6
Fog Lamp	£3 14 6
Rebound Wing Mirror	£1 2 6
Wing Mirror	19 6
Exterior Sun Visor (in Primer)	£4 5 0
Perspex Interior Visor	£1 12 6
Door Mirror	19 6
Roof Rack	£5 0 0
Reverse Lamp (Home only)	£3 0 0
Tow-bar Attachment	£7 5 0
Bonnet Mascot...	£1 1 0
Sheepskin Rugs—front compartment (R.H.D. only)	£7 12 2
Heater and Demister Kit	£12 0 0
Blower Kit (optional for temperate climates)	£4 10 0
Radio (including Aerial and Accessories) :						
Radiomobile De Luxe	£35 12 4
Radiomobile Standard	£23 7 6
Ekco	£22 15 0
Ekco Alternative Aerial—fully retractable	£2 5 0
Ekco Rear Extension Speaker with Volume Control	£3 2 6
Electric Clock	£5 10 3
Revolution Counter Kit (R.H.D. only)	£6 12 6
Hand-operated Windscreen Washer	£1 17 6
Multipurpose Cushion	£1 15 0
Liquid Polish	3 0
Wax Polish	5 0
Body Paint Touch-in Pens	4 9
Remote Control bonnet lock	13 0
Rootes Seat Covers	Prices on application
Safety Belt—front or rear seats	each	...	£3 5 0
Spare Wheel Cover	£1 10 0
Lamp Carriers	13 6
Radiator Blind	£3 6 0
Fire Extinguisher	£2 15 0
Tool Kit	£1 7 6
Bulb Kit	19 2
Badge Clip—screw fixing	3 6
Badge Clip—pillar stud fixing	5 3
Starting Handle (Home only)	5 0

Accessories listed refer to all models in the range unless otherwise stated

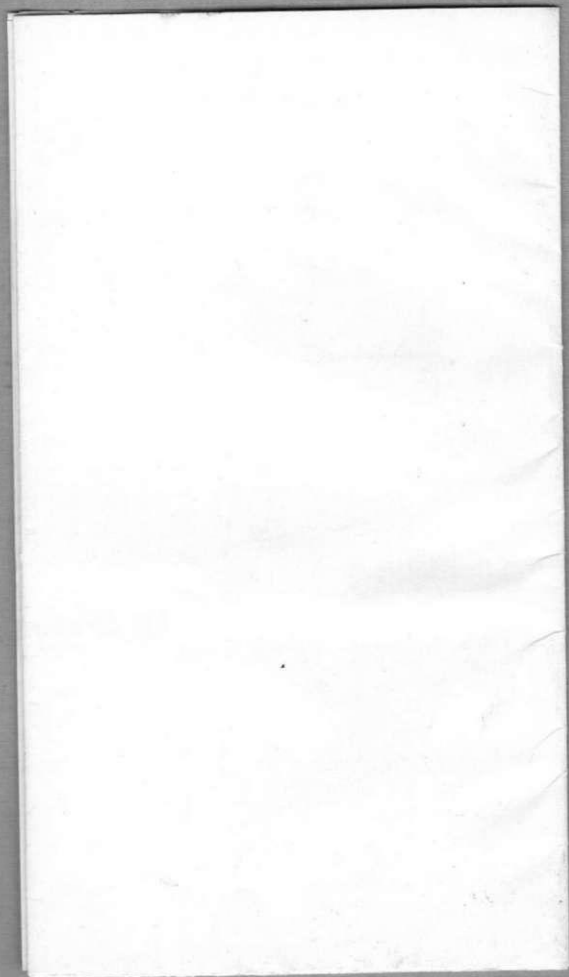

rest brompton entrance

philbeach exit

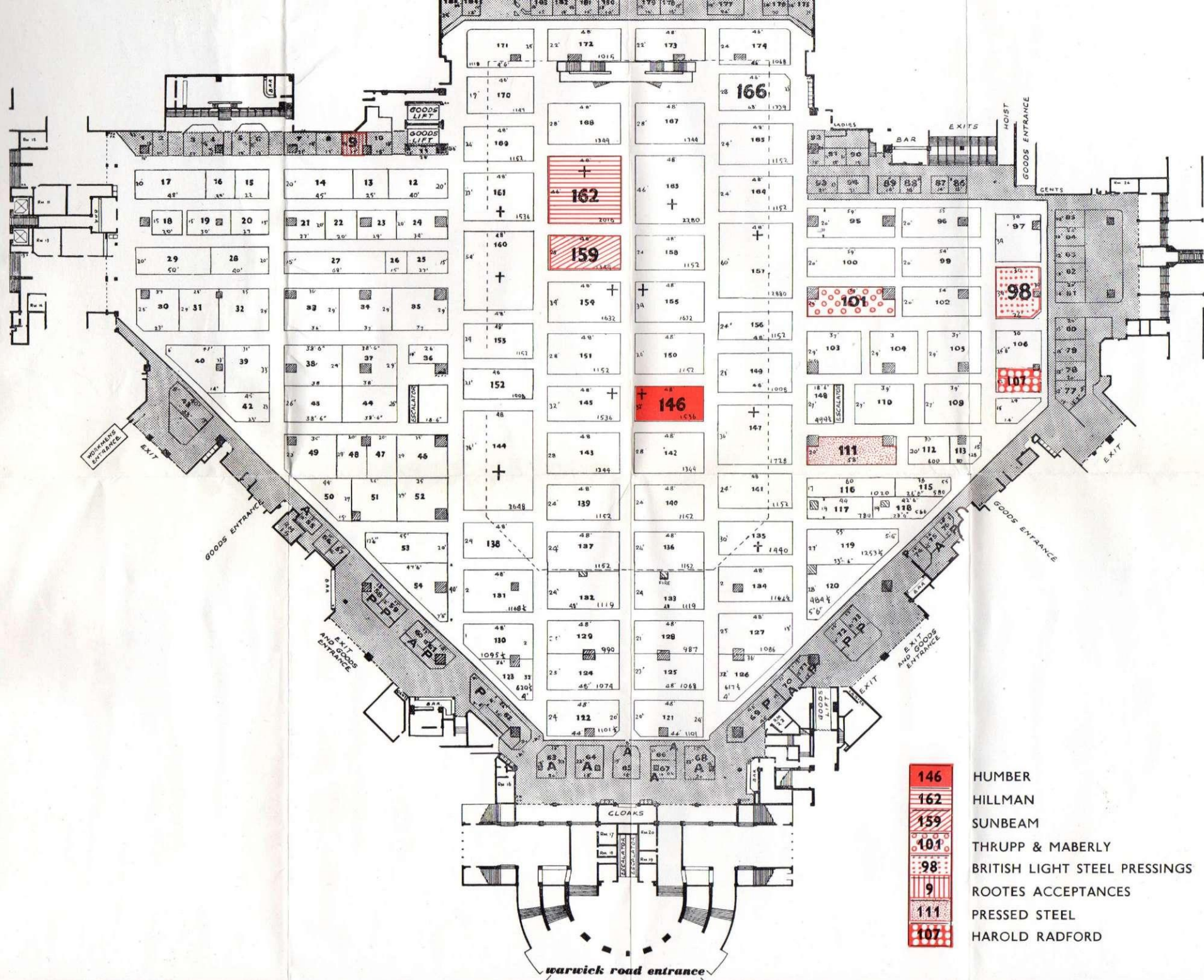

- 146 HUMBER
- 162 HILLMAN
- 159 SUNBEAM
- 101 THRUPP & MABERLY
- 98 BRITISH LIGHT STEEL PRESSINGS
- 9 ROOTES ACCEPTANCES
- 111 PRESSED STEEL
- 107 HAROLD RADFORD

